



VISHNU
PRIMUS



WHERE DREAMS COME TRUE

Find yourself spell bound in the luxurious world of Vishnu Primus - where you discover opulence which is nothing less than magic.

Ultramodern 3BHK & 4BHK apartments of Vishnu Primus offer world class amenities for a world class lavish experience. Now let the magic of life in luxury mesmerize you forever.



DIVE, LOVE, PLAY

OPEN PLAY AREA FOR CHILDREN ON FIRST FLOOR

A sprawling open play area for children on the first floor level, a beautifully decorated lobby at the ground floor, and everything else you see around is designed for an impeccable lifestyle.

It's created especially for the discerning buyer who appreciates the small detail as much as the big picture. For those who savour the fine things in life, Vishnu Primus is truly a dream haven.



VISHNU
PRIMUS
 THE ADDRESS OF PEACE



Standing 7 storeys tall, Vishnu Primus radiates serenity and privacy with its calm ambience and a stress free habitat.

It is strategically located on Sashi Shekhar Bose Row, minutes away from Alipur.

VICTORIA, RACE COURSE, ALIPUR & FORUM AT A DISTANCE OF : **5 MINS**



FACILITIES

- ❖ Lobby Decorated with Marble & Granite Tiles
- ❖ Vitrified Marble Flooring
- ❖ Intercom
- ❖ Generator*
- ❖ Filtered Water*
- ❖ Aluminium Windows
- ❖ Lifts

*Conditions Apply

SPECIFICATIONS



STRUCTURE : RCC framed structure

DOOR : Quality wooden frames and solid core flush panel shutters, decorative main door shutters

WINDOW : Aluminium windows

ELEVATION : Latest available durable outer finish

KITCHEN : Kitchen top granite and ceramic tiles till 2ft. of working platform with stainless steel sink

FLOORING : Vitrified marble

LOBBY : Vitrified marble flooring

ELECTRICAL : Copper wiring in concealed conduits, sufficient light and fan plugs in all bedrooms
AC points in all bedrooms, semi modular switches of reputed brands

TOILET : Glaze tiles dado
Hot & cold water supply in showers
European style WC
Elegant CP fittings of ISI mark
White colour sanitary ware of reputed make
Geyser point in all toilets

SITE PLAN



Unit A 3BHK
1,607 sq.ft.

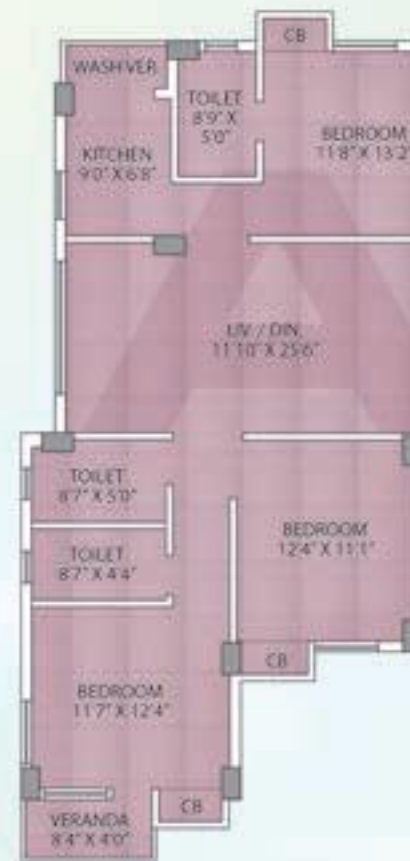

3BHK
1,528 sq.ft.

Unit D



Unit B 4BHK
1,907 sq.ft.

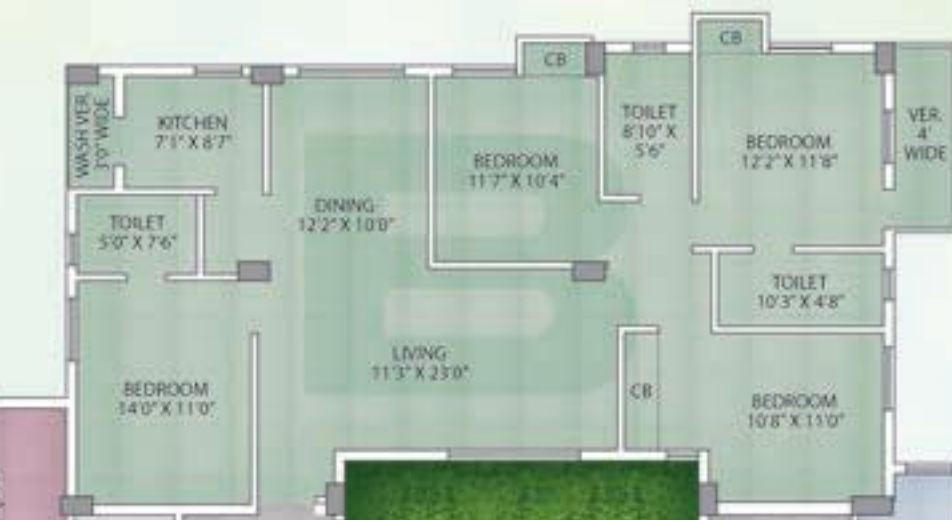

Unit C 3BHK
1,464 sq.ft.



TYPICAL FLOOR PLAN

1ST TO 6TH FLOOR



Vishnu Group is a recognized and admired brand which has moved from strength to strength over past three decades. The Group stands firm on commitments, not only to upkeep its tradition but to strive to improve its offering and service in providing "Value and Quality Housing". Its accomplishments consist of several residential and commercial complexes.

The Group's strength is delivery of its promises through meticulous planning, emphasizing on essential requirements, importance of location, connectivity and convenience, budget limitation of the customer, backed by quality material, workmanship and after sales service.

ONGOING PROJECTS



VISHNU PARADISE
88F, NSC Bose Road, Kolkata 700040



VISHNU MAHAMAYA
1052, Mahamayatala, Kolkata 700084



VISHNU REGENCY
486, Raynagar, Kolkata 700070



VISHNU KING'S COURT
227, NSC Bose Road, Kolkata 700040



Developer
HAPPY HOMES GROUP
Utsav Projects Pvt. Ltd.
11, Crooked Lane
Kolkata 700069
Ph 033 2248 2519
Email happyhomes@live.in



Consultant
M/S CHAKRABARTI GROUP
Gautam Chakrabarti
60 Muzaffar Ahmed Street
Kolkata 700016
Ph 033 2226 4646

For Details
91631 71728
98300 59217
98300 13580

Site
1/1, Sashi Sekhar Bose Row
Kolkata 700025

Disclaimer: This is a Conceptual presentation and not a legal document, the specifications given are subject to change.